

THIS INFORMATION IS CONFIDENTIAL AND THE PROPERTY OF SIRIUS. IT IS RELEASED ON CONDITION THAT NONE OF THE INFORMATION SHALL BE DISCLOSED TO ANY THIRD PARTY OR REPRODUCED IN WHOLE OR PART WITHOUT THE PRIOR CONSENT IN WRITING OF SIRIUS.

Coed yr Aber

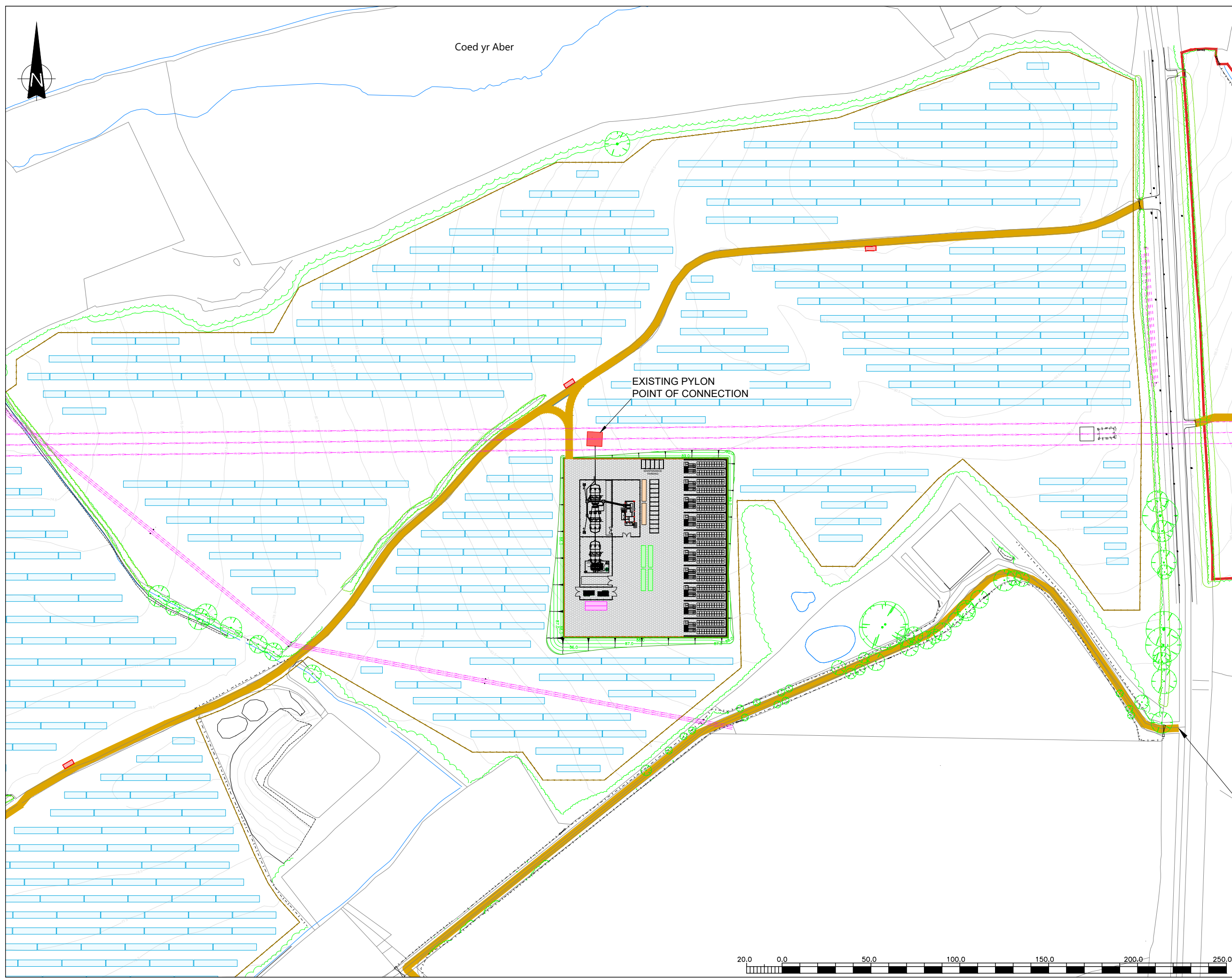

EXISTING PYLON
POINT OF CONNECTION

- KEY**
- EXISTING HV OH CABLES
 - EXISTING POST AND WIRE FENCE
 - EXISTING HEDGES
 - EXISTING TREES
 - EXISTING GROUND CONTOURS
 - PROPOSED SUBSTATION & BESS COMPOUND PLATFORM CONTOURS
 - PROPOSED PALISADE SECURITY FENCE
 - PROPOSED ACOUSTIC FENCE
 - PROPOSED PERIMETER DEER FENCE
 - PROPOSED PALADIN SECURITY FENCE
 - PROPOSED ACCESS TRACK
 - PROPOSED GRAVELLED AREA
 - PROPOSED SOLAR PANELS
 - PROPOSED INVERTERS
 - BATTERY / INVERTER / TRANSFORMER BAY WITH 3m HIGH CONCRETE FIREWALLS
 - SPARES/STORAGE CABIN
 - CONTAINERS
 - SOLAR AND BESS DNO SUBSTATIONS
 - SOLAR AND BESS SWITCHGEAR CABINS
 - 132KV SUBSTATION

| REV | DESCRIPTION | DATE | BY |
|-----|-------------|------|----|
| | | | |

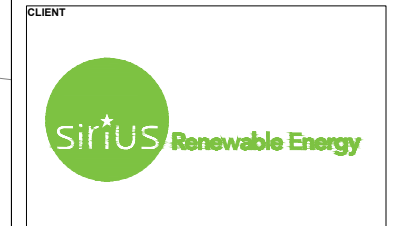

JOB TITLE
OAKLANDS SOLAR FARM AND BATTERY STORAGE

DRAWING TITLE
POINT OF CONNECTION DETAILS

| DRAWN | DATE | APPROVED | DATE |
|--------|----------|----------------|----------|
| S.T | 1/9/2022 | J.C | 1/9/2022 |
| SCALE | SHEET | DRAWING NUMBER | REVISION |
| 1:2000 | A3L | SRE1113/02/14 | 0 |

